

**GENERAL CONSTRUCTION NOTES FOR SECOND FLOOR**

- 1 PATCH AND REPAIR EXISTING PLASTER WALLS AS REQUIRED AT ALL DAMAGED LOCATIONS AT ALL HOLES, CHIPS, CRACKS AND WHERE EMBEDDED ITEMS HAVE BEEN REMOVED.
- 2 REPAIR AND REFINISH EXISTING DOOR, FRAME AND HARDWARE.
- 3 REPAIR AND REFINISH EXISTING GLASS PANELED DOOR, SIDELIGHT AND TRANSOM LIGHT. REPAIR AND REFINISH EXISTING HARDWARE. CLEAN EXISTING GLASS PANELS. RE-INSTALL EXISTING GLASS PANELED DOOR AND SIDELIGHT. SALVAGED FROM STOCKPILE IN THE BASEMENT.
- 4 STRIP AND REFINISH EXISTING WOOD WALL AND BASE CABINETS.
- 5 NEW STAINLESS STEEL SINK WITH PLASTIC LAMINATE WALL AND BASE CABINETS.
- 6 CLEAN EXISTING CERAMIC TILE FLOOR, BASE AND GROUT. REPAIR GROUT AS REQUIRED.
- 7 REPAIR DAMAGED AREAS OF EXISTING CERAMIC WALL TILE.
- 8 EXISTING WALL MURALS TO REMAIN.
- 9 CLEAN EXISTING TERRAZZO STAIR TREADS AND LANDING. CLEAN AND PAINT EXISTING STEEL RISERS AND NOSINGS.
- 10 CLEAN EXISTING STEEL PICKETS AT STAIR QUADRAL. REFINISH EXISTING WOOD HANDRAIL.
- 11 CLEAN AND POLISH EXISTING BRASS HANDRAIL, POST AND RAIL PLATES.
- 12 NEW STEEL TRASH CHUTE IN 2 HOUR FIRE RATED ENCLOSURE.
- 13 NOT USED.
- 14 NEW 2 HOUR FIRE RATED CHASE FOR FIRE ALARM RISER. COORDINATE REQUIREMENTS WITH ELECTRICAL DRAWINGS. CHASE SHALL BE GFS/SLU BD. SHAWT WALL CONSTRUCTION.
- 15 EXISTING ELEVATORS TO BE MODERNIZED. SEE SPECIFICATIONS.
- 16 NEW STEEL LADDER TO NEW ROOF ACCESS HATCH, SEE SECTION 2/DWG. A-700.
- 17 INSTALL NEW FIRE EXTINGUISHER W/ CABINET AT LOCATIONS INDICATED BY SYMBOL 18.

**SECOND FLOOR DOOR SCHEDULE**

DOOR MARK	DOOR SIZE	DOOR		FRAME		FIRE RATING	HARDWARE GROUP	NOTES
		TYPE	MATL.	TYPE	MATL.			
200	3'-0" x 7'-0"	3	WD	3	HM	-	-	1
201	3'-0" x 7'-0"	3	WD	3	HM	-	-	
202	3'-0" x 7'-0"	3	WD	3	HM	-	-	
203	3'-0" x 7'-0"	3	HM	5	HM	1 1/2HR	-	
204	3'-0" x 7'-0"	3	HM	5	HM	1 1/2HR	-	

NOTES: 1. FIELD VERIFY EXIST. ROUGH OPENING BEFORE FABRICATION OF DOOR

**DOOR TYPES**

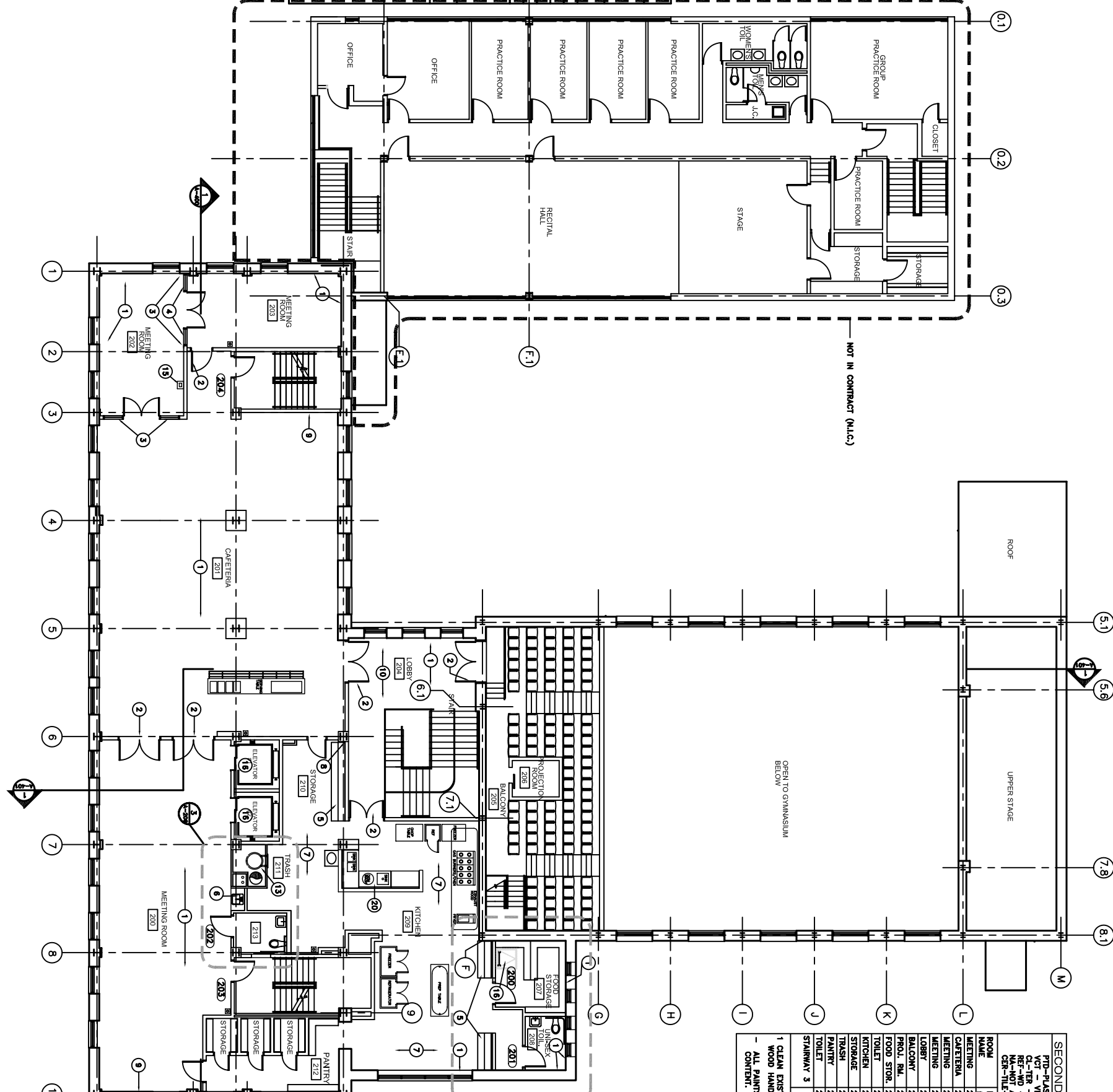
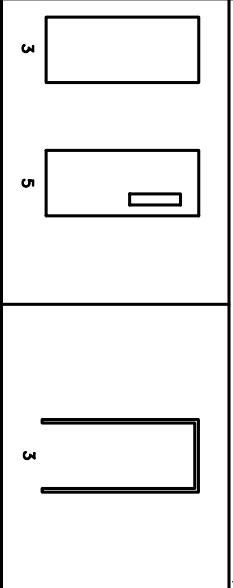

**SECOND FLOOR ROOM FINISH SCHEDULE**

ROOM NAME	NO.	FLOOR	BASE	WALL	CEILING	NOTE
MEETING	200	CARPET	WOOD	PFD-PLAS	LAY-IN	
CAETERIA	201	VCT	VNLT	PFD-PLAS	LAY-IN	
MEETING	202	CARPET	WOOD	PFD-PLAS	LAY-IN	
MEETING	203	CARPET	WOOD	PFD-PLAS	LAY-IN	
LOBBY	204	CL-TER	VNLT	PFD-PLAS	PFD-PLAS	
BALCONY	205	NA	NA	NA	NA	
PROJ. RM.	206	NA	NA	NA	NA	
FOOD STOR.	207	VCT	VNLT	PFD-GRP	LAY-IN	
TOILET	208	VCT	VNLT	PFD-GRP	LAY-IN	
KITCHEN	209	CL-CER	CL-CER	PAINT	LAY-IN	
STORAGE	210	CL-CER	CL-CER	PAINT	LAY-IN	
TRASH	211	CL-CER	CL-CER	PAINT	LAY-IN	
PANTRY	212	CL-CER	CL-CER	PAINT	LAY-IN	
TOILET	213	CL-ET/ST	CL-ET/ST	PFD-PLAS	PFD-PLAS	1
STAIRWAY	3	CL-ET/ST	CL-ET/ST	PFD-PLAS	PFD-PLAS	1

1 CLEAN EXIST. TERRAZZO WHERE APPLICABLE. REFINISH EXIST. WOOD HANDRAILS. PAINT EXIST. STL. PICKETS AND STRINGERS  
 - ALL PAINTS, PRIMER AND SEALANTS SHALL HAVE LOW VOC CONTENT. ALL CARPETS SHALL BE GREEN LABEL CARPET.

**Emeritus House  
Historic Restoration**  
 4450 Cedar Avenue  
 Cleveland Ohio, 44103

**Robert P. Madison International, Inc**  
 Architects · Engineers · Planners  
 2930 Euclid Avenue  
 Cleveland, Ohio 44115  
 Tel. 216-881-8195 Fax. 216-821-8738

**POINT ONE DESIGN, LTD**  
 Consulting Engineers  
 Tel: (440) 230-1888 Fax: (440) 230-1831

**Developers:**  
 PVA ENTERTIS LLC  
 Phillip Wheatley  
 4450 Cedar Avenue  
 Cleveland, Ohio 44103  
 Tel. 216-881-4443  
 Fax. 216-791-6685

**Contractors:**  
 Marous Brothers  
 Construction  
 1702 Joseph Lord Parkway  
 Willoughby, OH 44094  
 Cleveland, Ohio 44115  
 Tel. 440-951-3804  
 Fax. 440-951-3701

**Building Managers**  
 ABC Management  
 P.O. Box 228055  
 22875 Commerce Park  
 Cleveland, Ohio 44122  
 Tel. 216-591-0881  
 Fax. 216-591-1182

**REVISIONS**

NO.	DATE	REMARK

DATE: 6-9-08  
 SCALE: 1/8"=1'-0"  
 DRAWN: RKM  
 CHECKED: RKM  
 PROJECT NO.: 0329

Second Floor Plan  
**A-202**